

Endwall Flashing

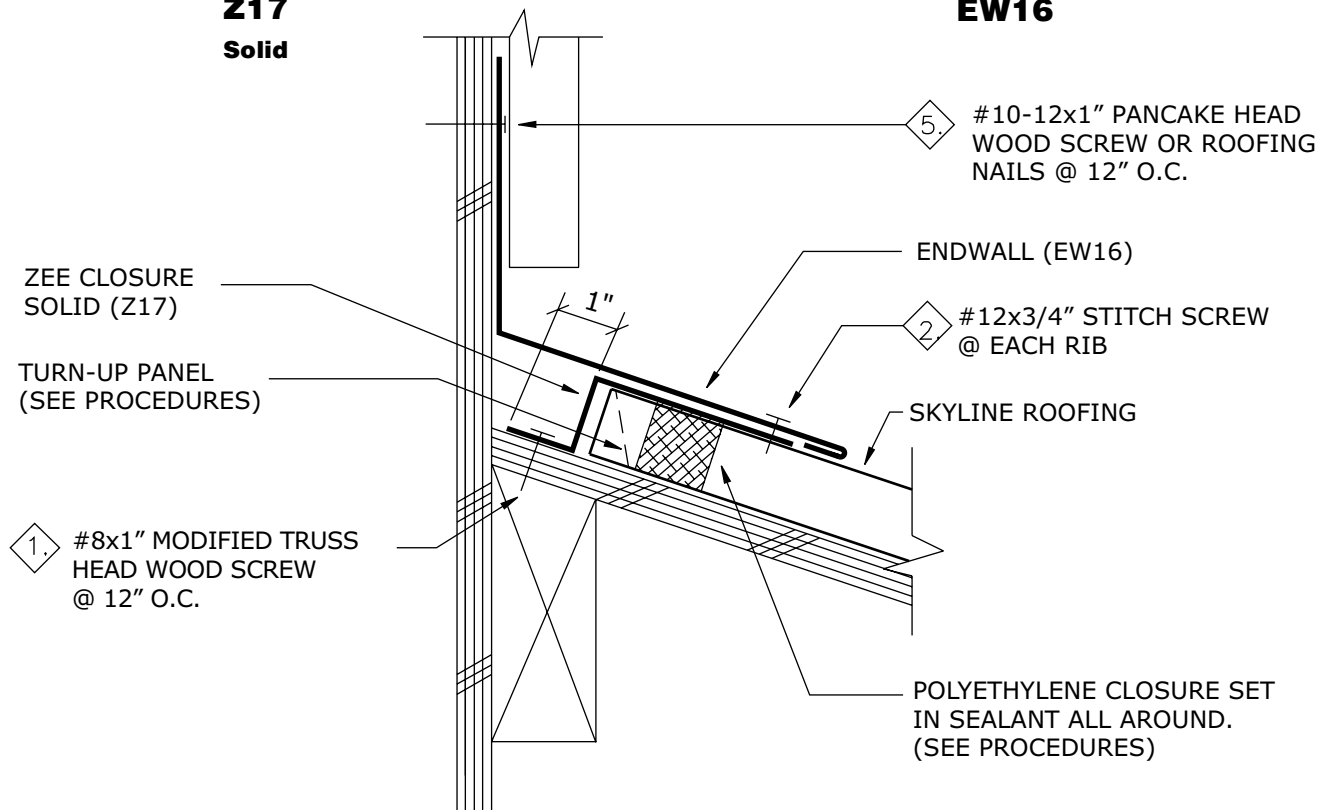

Z17
Solid

EW16



Procedures

- Locate the panels down from the endwall as required.
- Caulk (ProSeal 34 is recommended) the bottom and sides of the polyethylene closure, set the closure as shown above and caulk the top. The closure is an option if the panels are turned-up and caulked at the sides near the ribs.
- Attach the zee closure "Z17" (solid) at the top edge of the roof and parallel to the endwall.
- Provide space between the zee closure "Z17" and the end of the panel to allow for expansion of the panel.
- Fasten the endwall "EW16" with pancake head wood screws or roofing nails at 24" o.c.
- Fasten the endwall "EW16" to the zee using #12 x 3/4" stitch screws at each rib (Adjacent to the panel ribs when possible).
- Caulk (ProSeal 34 is recommended), lap and rivet sequential flashings. (See pg. 48).