

Sidewall Flashing

For panels greater than 40 feet.

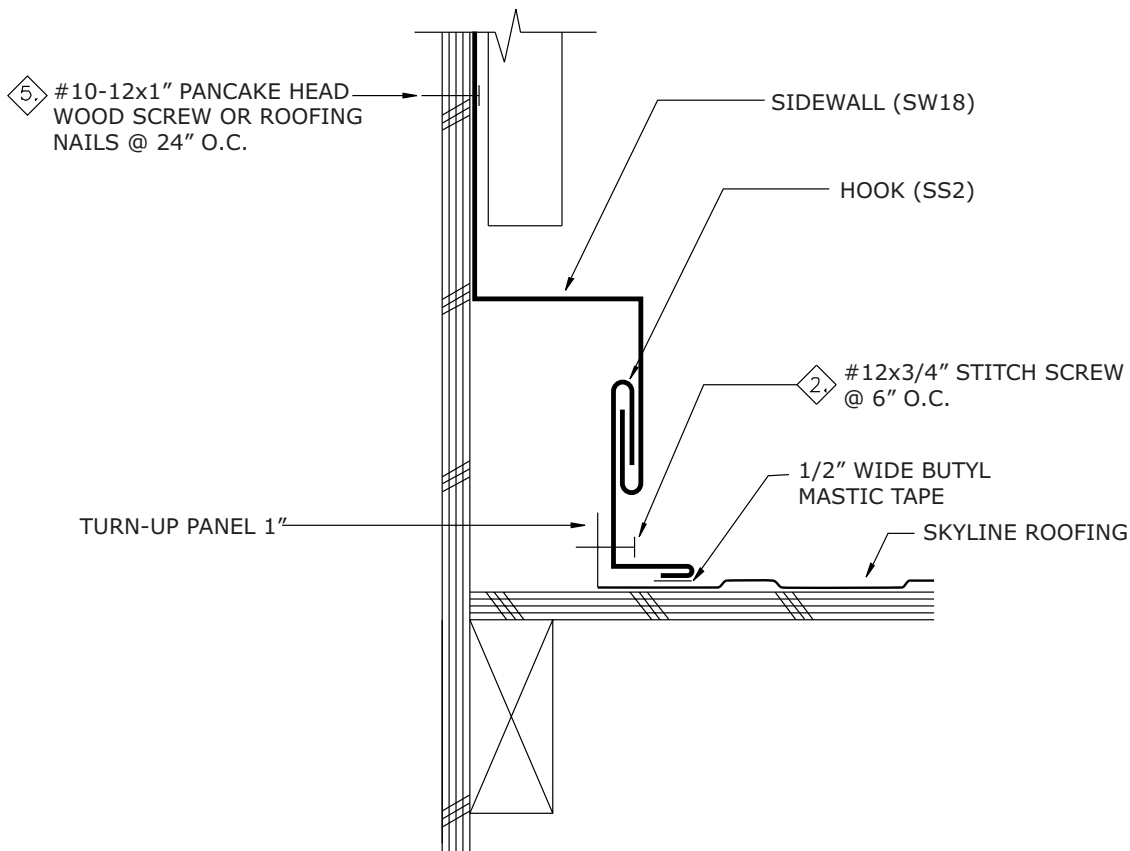
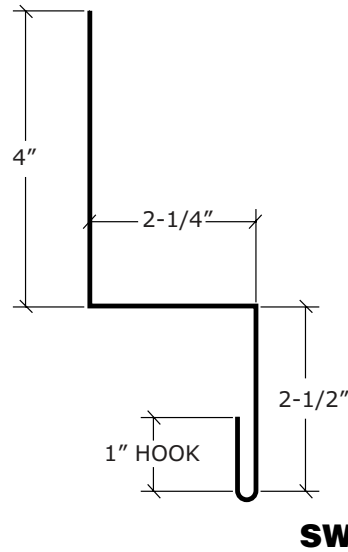
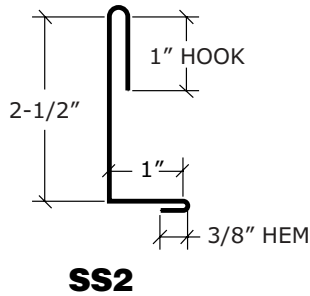

Procedures

- The roof and flashings should be installed prior to siding.
- Trim the panel 1" in and parallel with the wall.
- Turn up the panel 1" from the edge of the panel as shown.
- Apply mastic tape to the hook (SS2) before fastening.
- Fasten hook (SS2) to the turn-up. Make sure panel is able to expand and contract.
- See page 27 on closing the end of the flashing.
- Install the sidewall flashing (SW18) by hooking it into the hook (SS2) and then fastening it to the wall.