

Sidewall Flashing

For panels shorter than 40 feet.

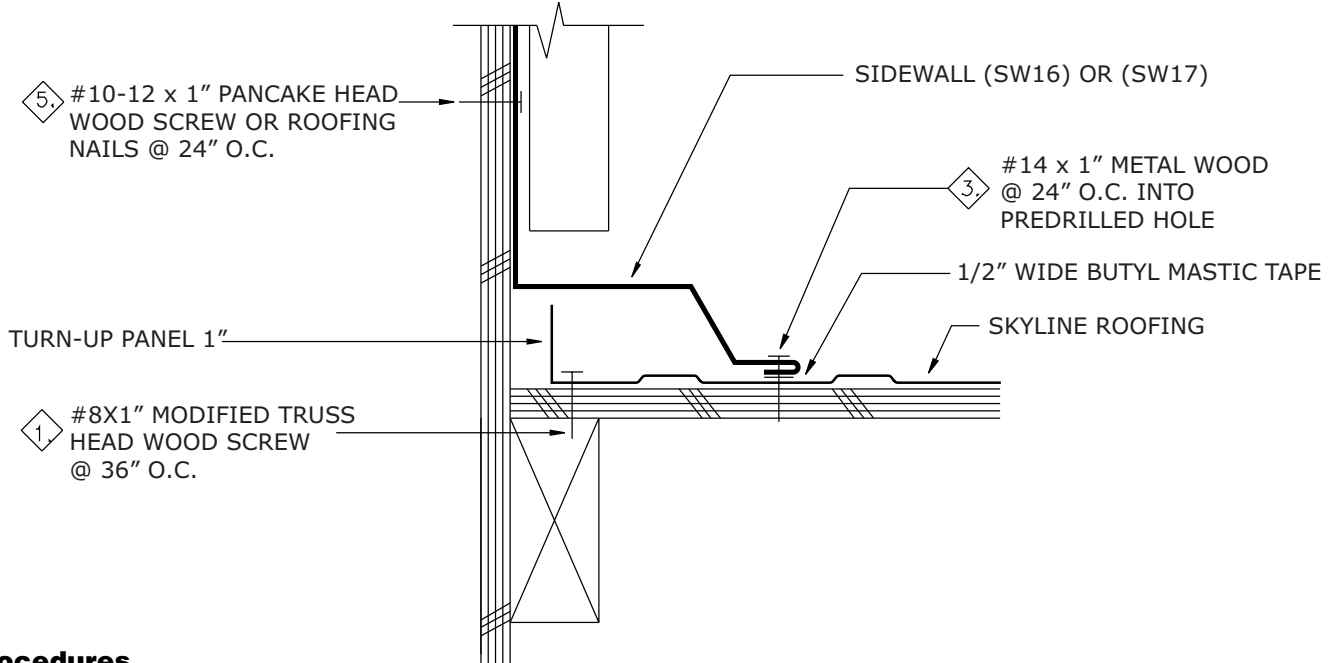
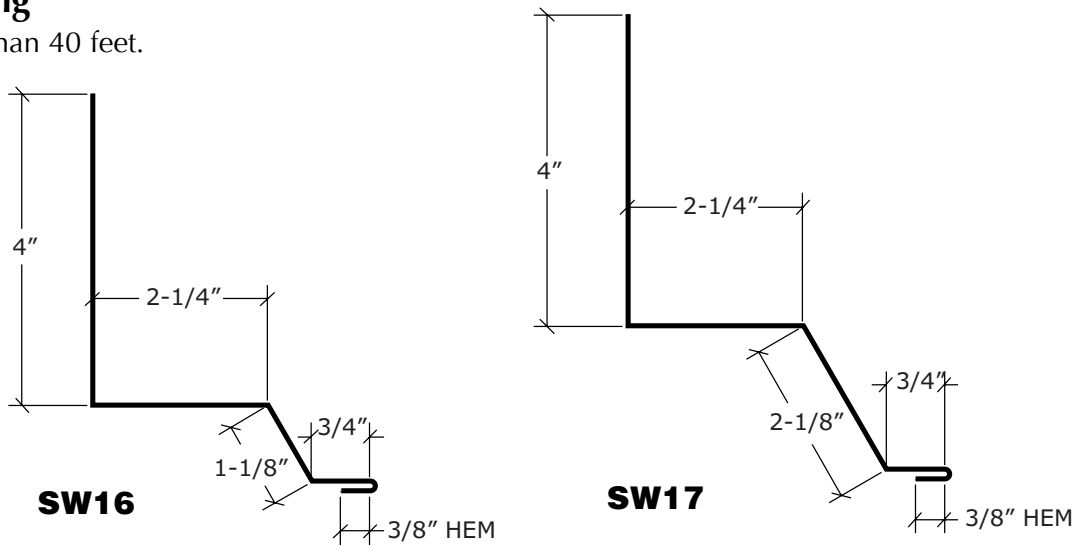

Procedures

- The roof should be installed prior to the siding.
- Trim the panel 1/2" in and parallel with the wall.
- Place butyl mastic tape along the sidewall flashing's flange as shown.
- Install the sidewall flashing "SW16" (when used with a standard endwall) by placing it firmly on the roofing panel and fastening with the fasteners indicated.
- Caulk (ProSeal 34 is recommended) and lap the flashing a minimum of 3" joining the hem. (See pg. 48).
- See page 27 on closing the end of the flashing.
- When using a sidewall flashing in conjunction with a vented endwall condition, increase the 1-1/8" leg on sidewall flashing, "SW16", to 2-1/8" ("SW17").

Note: Do not use this detail if panels are greater than 40 ft.