

Vented Endwall Flashing

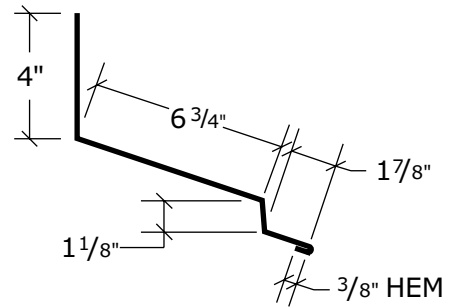

Z16
Perforated

EW17

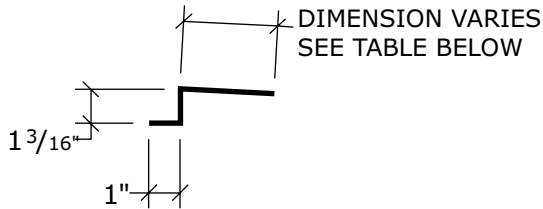
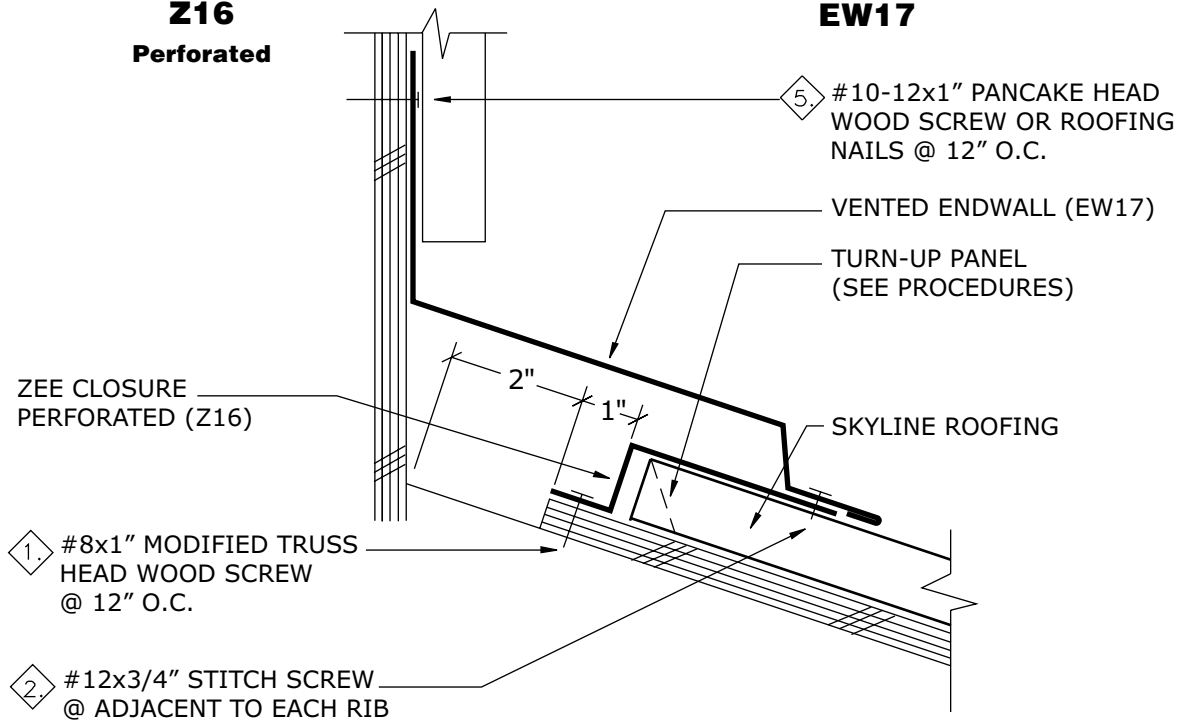

Procedures

- Plywood should be held back 2" from the wall.
- Locate the panels down from the edge of the plywood as required. Provide space between the zee closure "Z16" and the panel to allow for expansion of the panel.
- Turn-up pan of panel and caulk (ProSeal 34 is recommended) at the sides near the ribs. For increased weather tightness add a neoprene closure below panel turn-up.
- Attach the vented zee closure "Z16" (perforated) at the top edge of the plywood and parallel to the endwall.
- Fasten the vented endwall "EW17" with #10-12 x 1" pancake head wood screws or roofing nails at 24" o.c.
- Fasten the vented endwall "EW17" to the zee closure "Z16" (perforated) using #12 x 3/4" stitch screws. (Adjacent to the panel ribs when possible).
- Caulk (ProSeal 34 is recommended), lap and rivet sequential flashings. (See pg. 48).

Roof Pitch	Dimension
3:12-6:12	4 1/2"
7:12-9:12	3 3/4"
10:12-12:12	3"