

## Drip Flashing

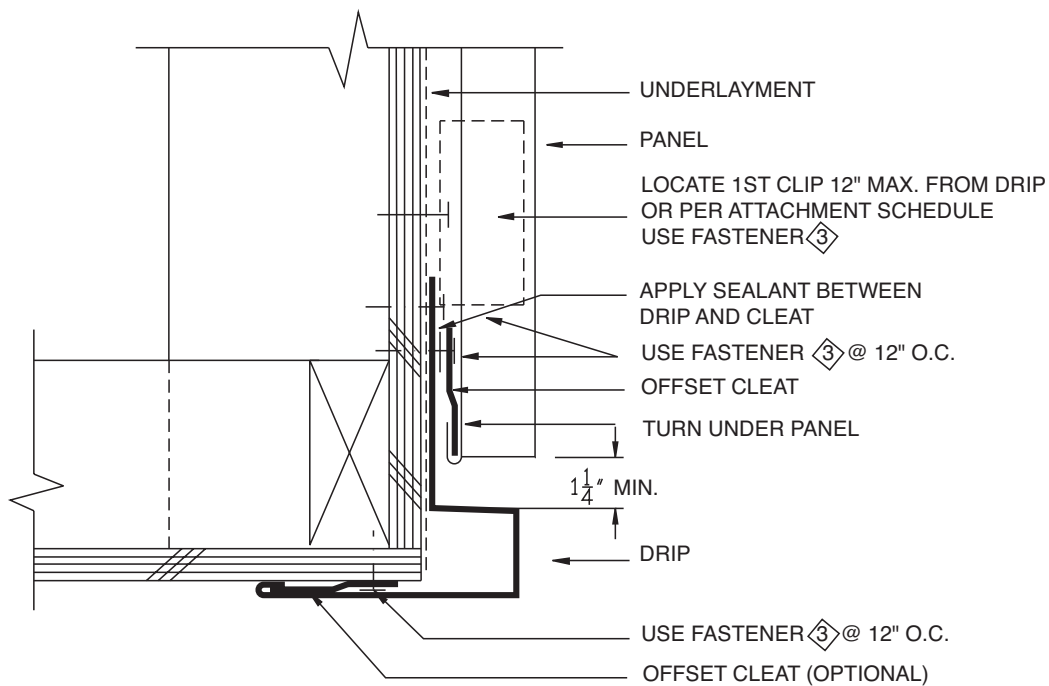
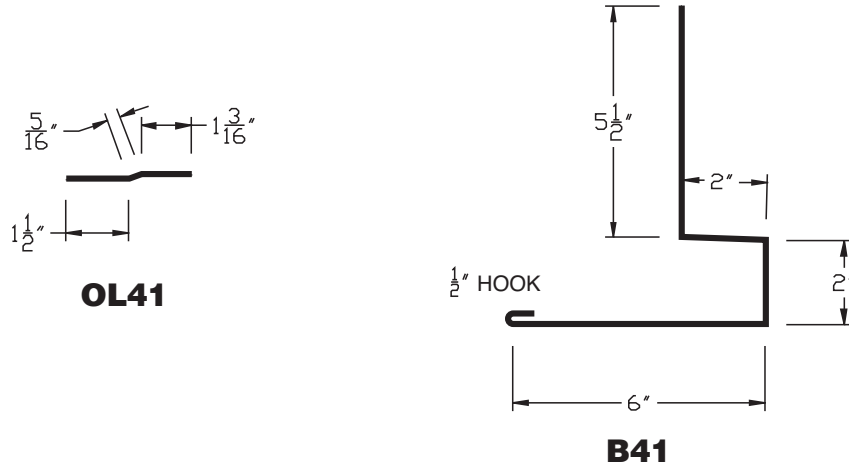

### Procedures

- Locate and fasten the offset cleat for the drip flashing. If the cleat is not used the horizontal leg of the drip flashing must be fastened through to the substrate with a #14x1" metal to wood screw every 24" o.c. max
- Locate the offset cleat so that the fascia panels can hook around it. Allow at least 1 1/4" clearance as shown.